

MONTERINGSANVISNINGAR  
INSTALLATION  
MONTAGEANLEITUNG  
INSTRUCTIONS MONTAGE  
INSTRUCCIONES DE MONTAJE  
ISTRUZIONI DI MONTAGGIO

# FUMEX<sup>®</sup> PR LED/T

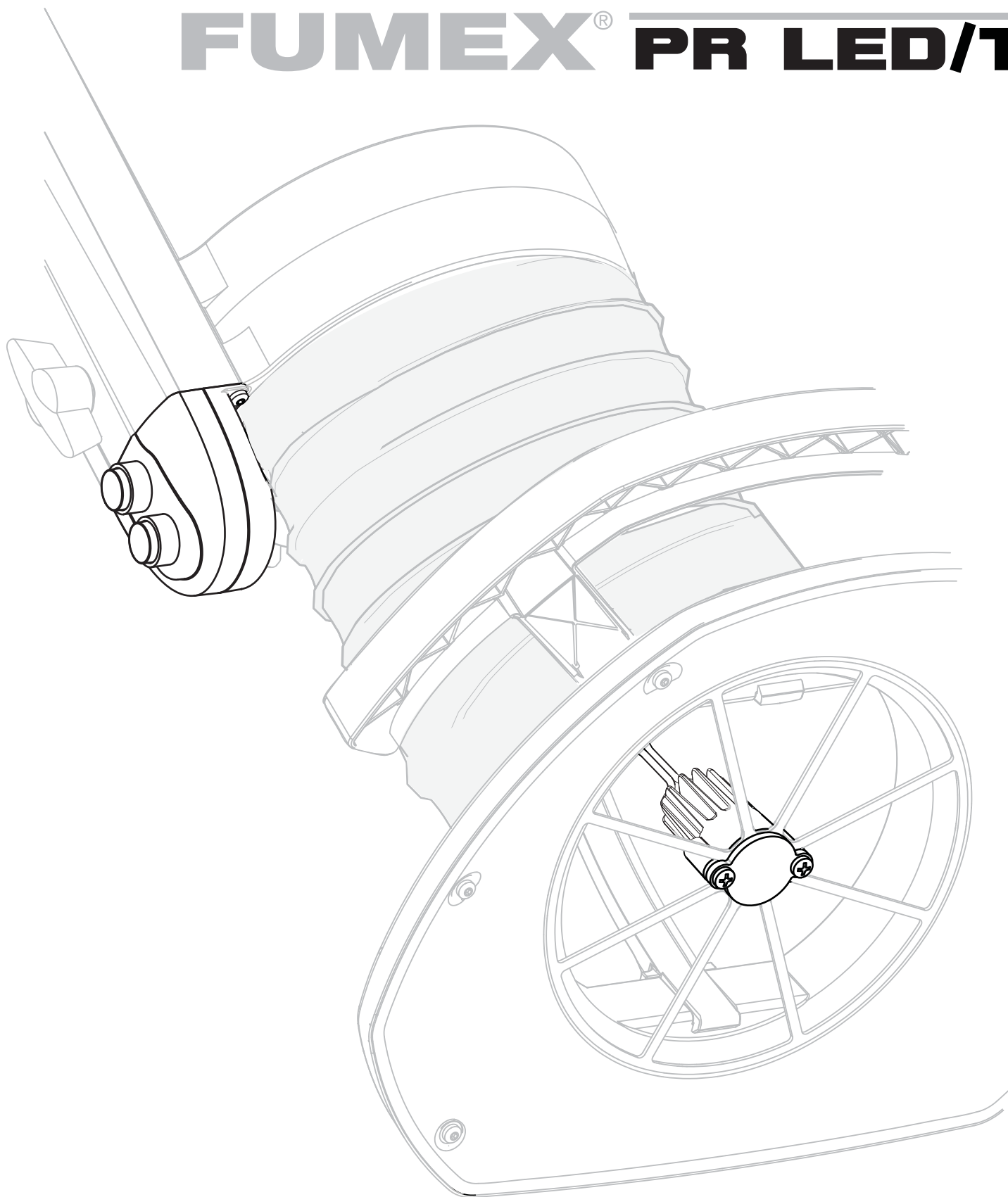

1

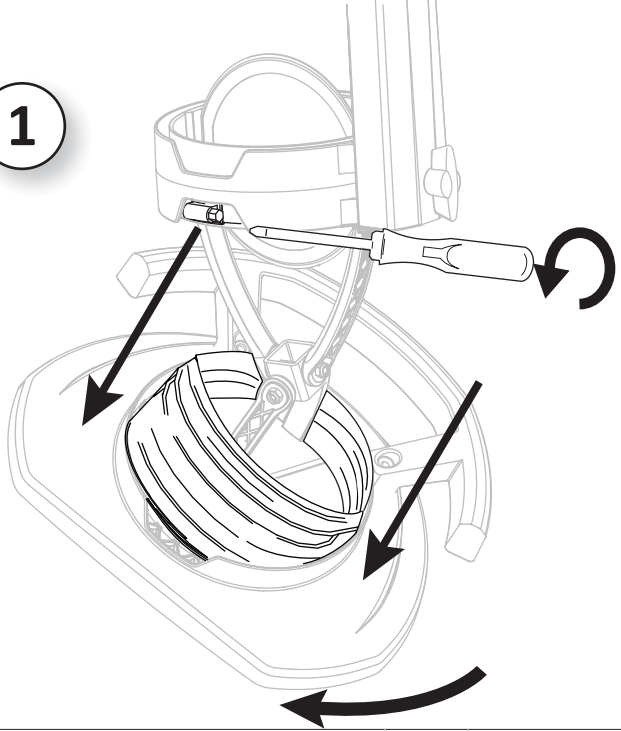

2

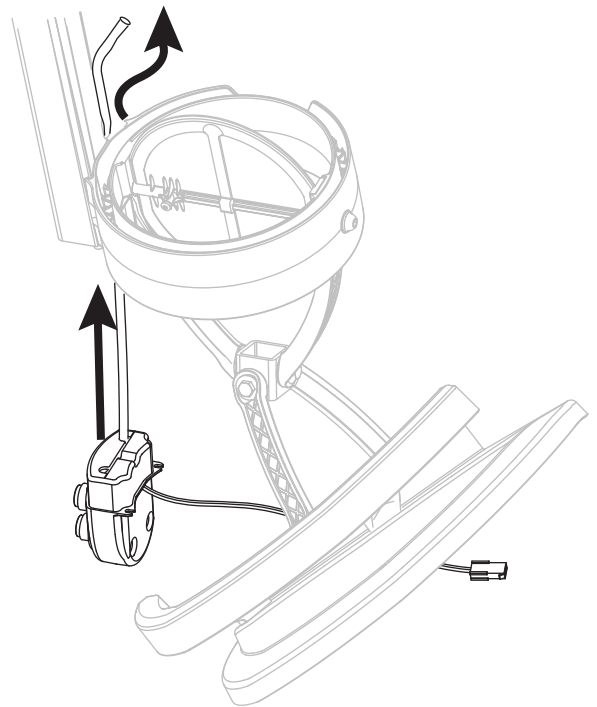

3

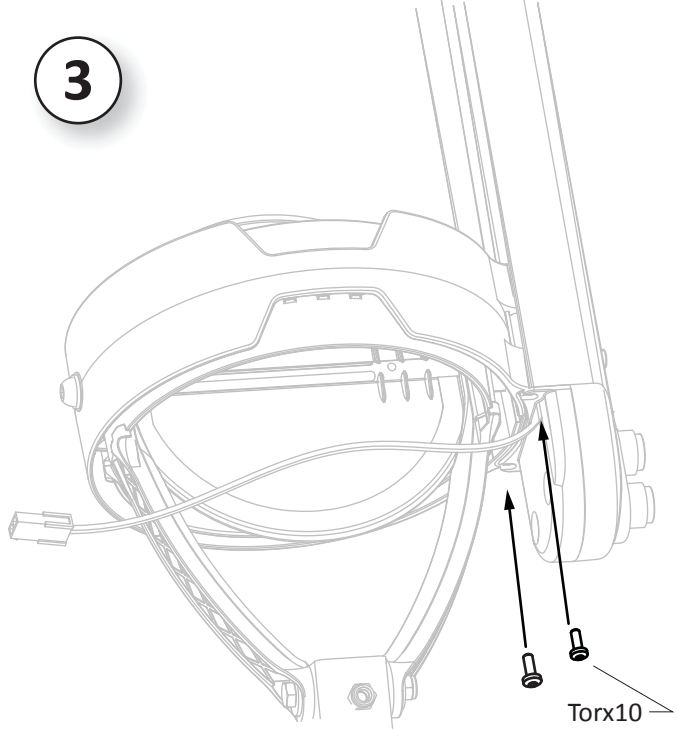

4

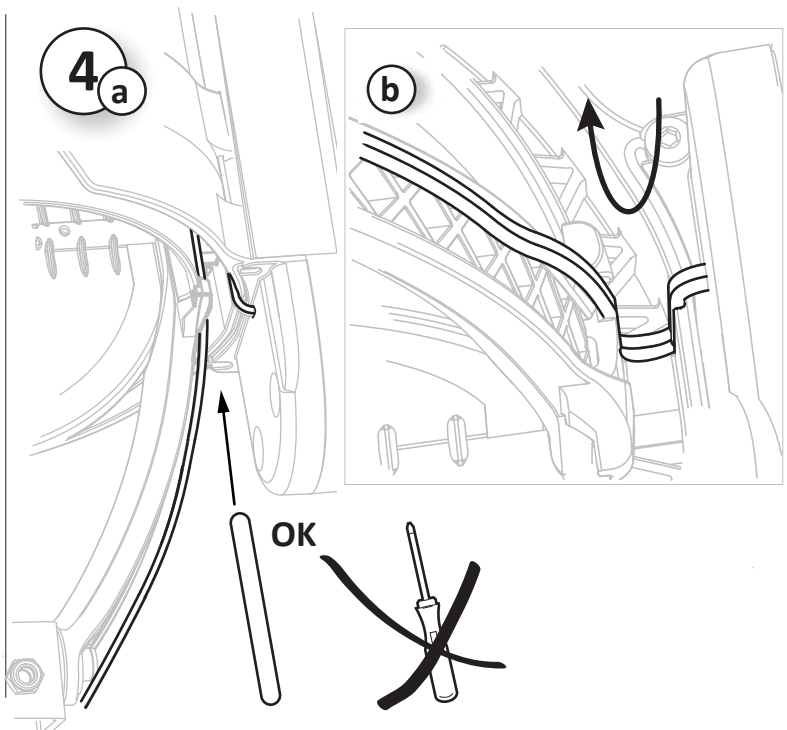

5

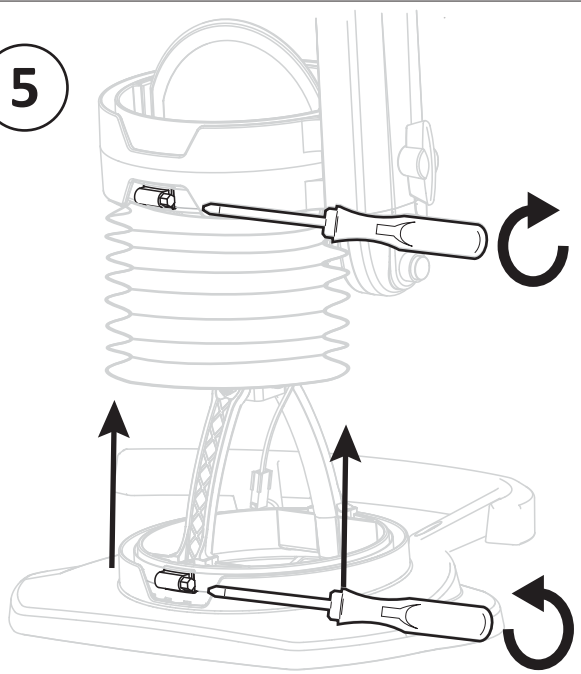

6

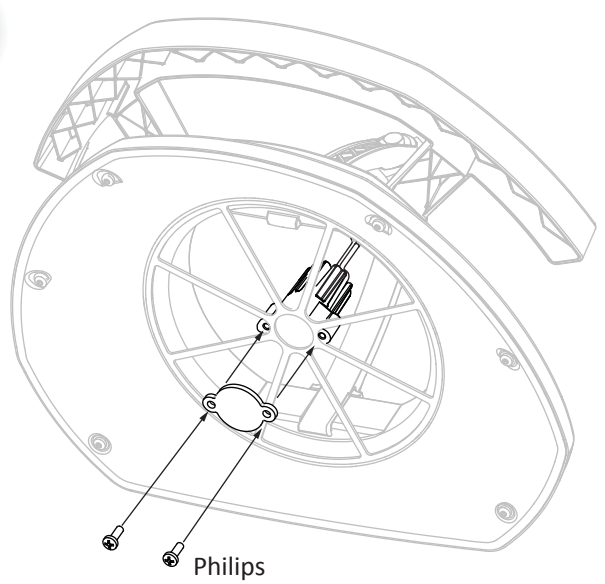

7

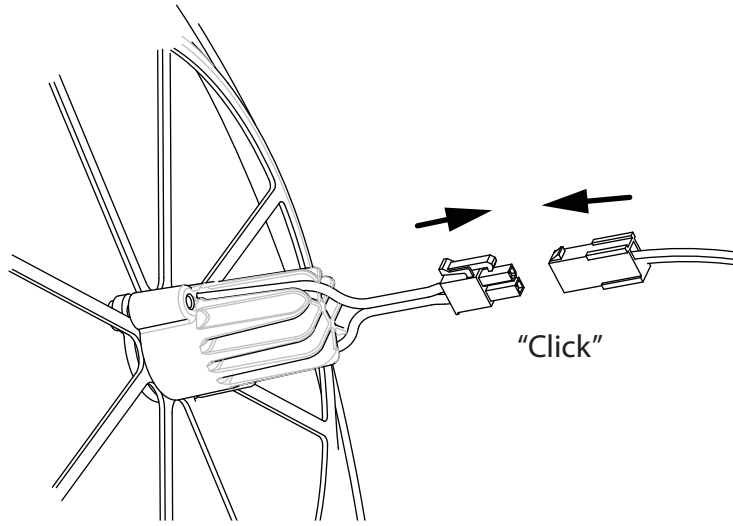

8

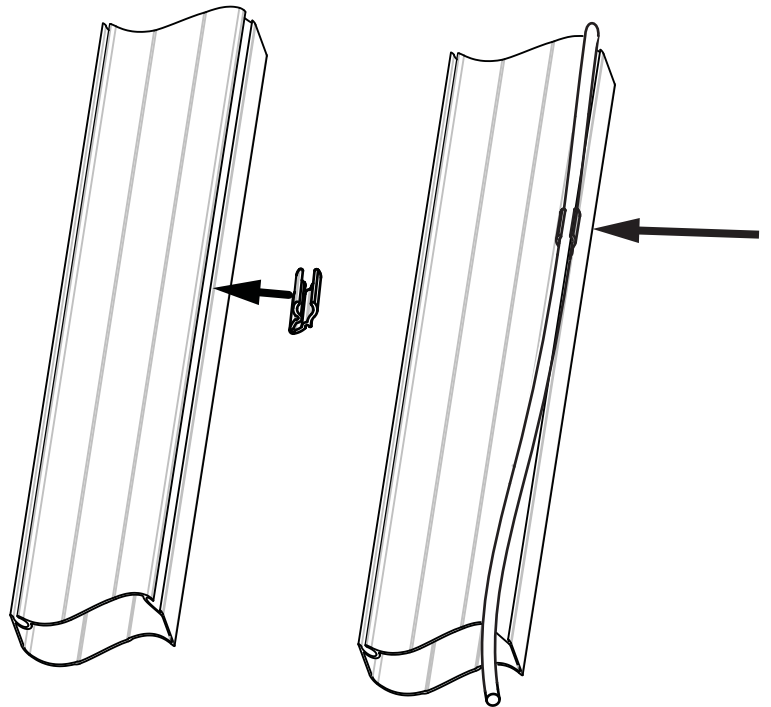
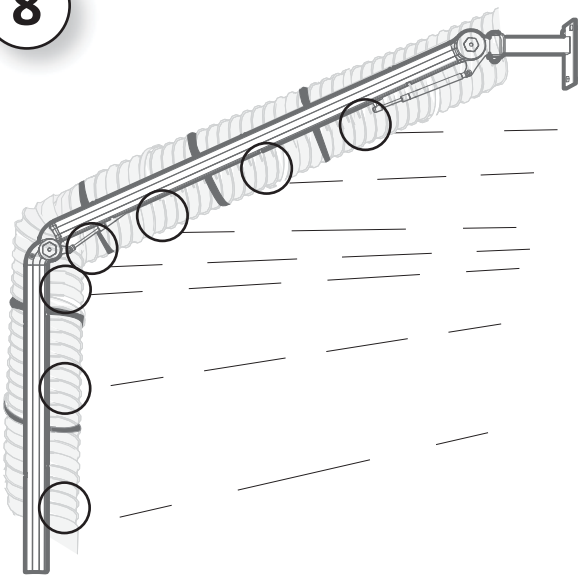

T

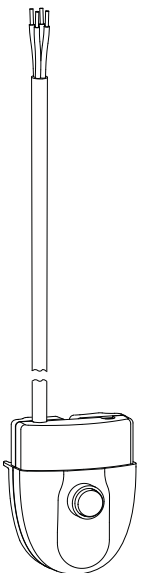

LED

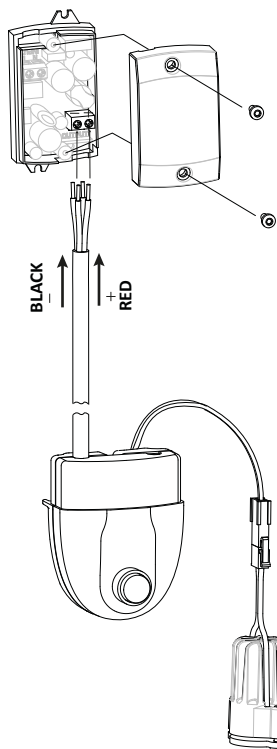

LED/T

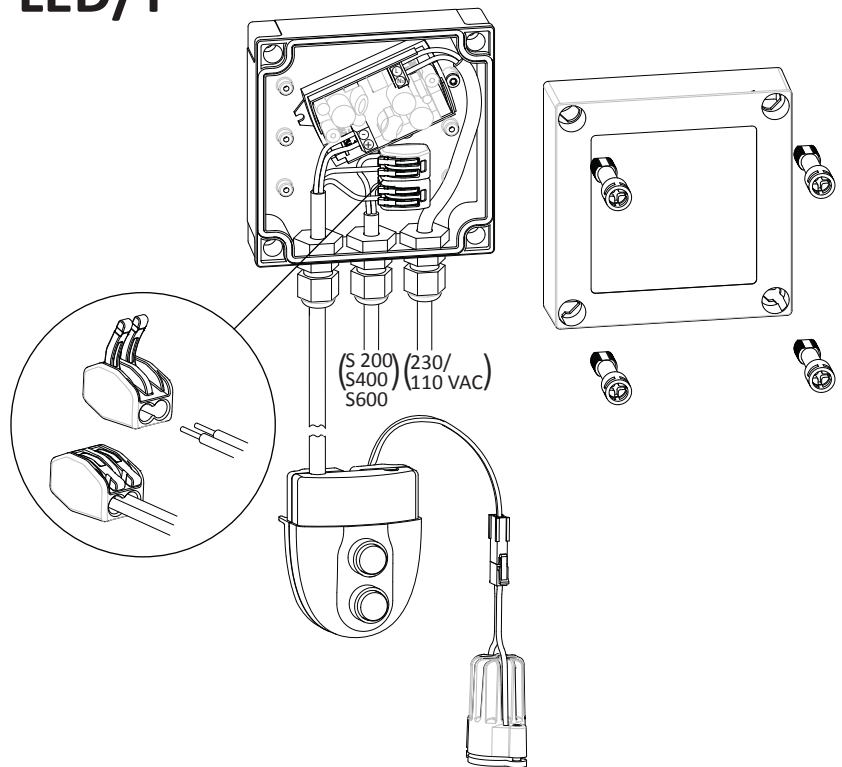

## Utförande

Tryckknappssatserna PR T, PR LED och PR LED/T är utvecklade för enkel start/ stopp av exempelvis lampa, fläkt och spjäll. Vid drivning av LED lampa används medföljande strömförsörjning.

Strömförsörjningen har inbyggd AC/DC omvandlare och förser lampan med konstant ström (350mA).

Max en lampa kan anslutas.

## Installation

Plint INPUT, 100-240V 1N~ (1).

Plint OUTPUT, 3-21VDC @350mA (2).

## Tekniska data

Effekt:	Max 6W
Frekvens:	50-60 Hz
Plint:	Max 1,5 mm <sup>2</sup> /terminal
Omgivande temp.:	0 till +50°C
Vikt:	33 gram

## Uppfyller standarder

Belysningsmateriel - Allmänt: EN 61347-1

Belysningsmateriel - Säkerhet: EN 61347-2-13

RoHS direktivet: 2011/65/EU

## Kapsling

Material: PCB

Täthetsklass: IP 20

Dimension: 68x36x21 mm

## Skötsel

Underhållsfri

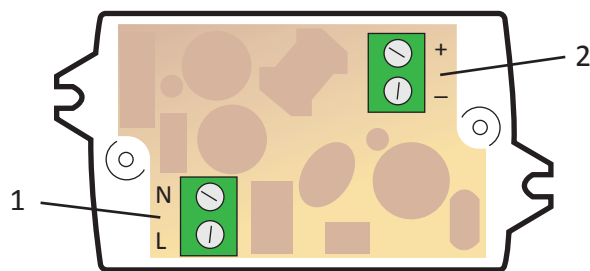

## T

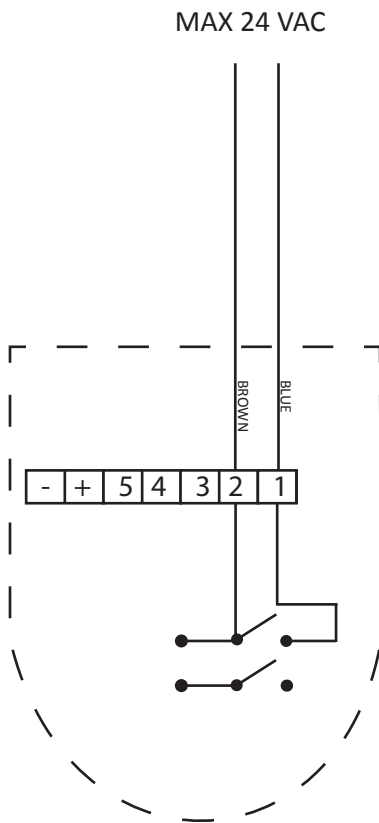

## LED

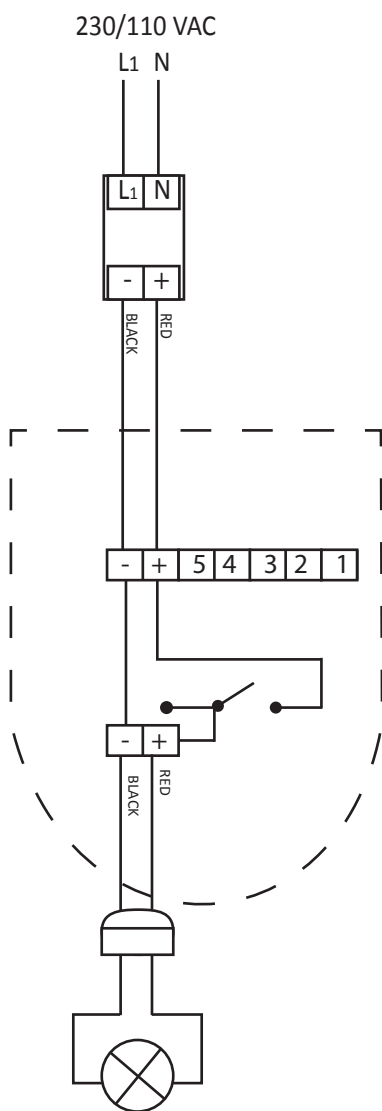

## LED/T

